

Nokia Customer Care
RH-19/RH-50 Series Cellular Phones

2(a) - Parts List & Layouts

This page has been intentionally left blank

Table of Contents

	Page No
Mechanical Parts of Nokia 3100 and 3100b.....	5
Assembly Parts List	6
Parts List PWB Module for RH-19/RH-50	8
PWB Mx7 Components	8
Component layout diagram Top	27
Component layout diagram Bottom	28

This page has been intentionally left blank

Mechanical Parts of Nokia 3100 and 3100b

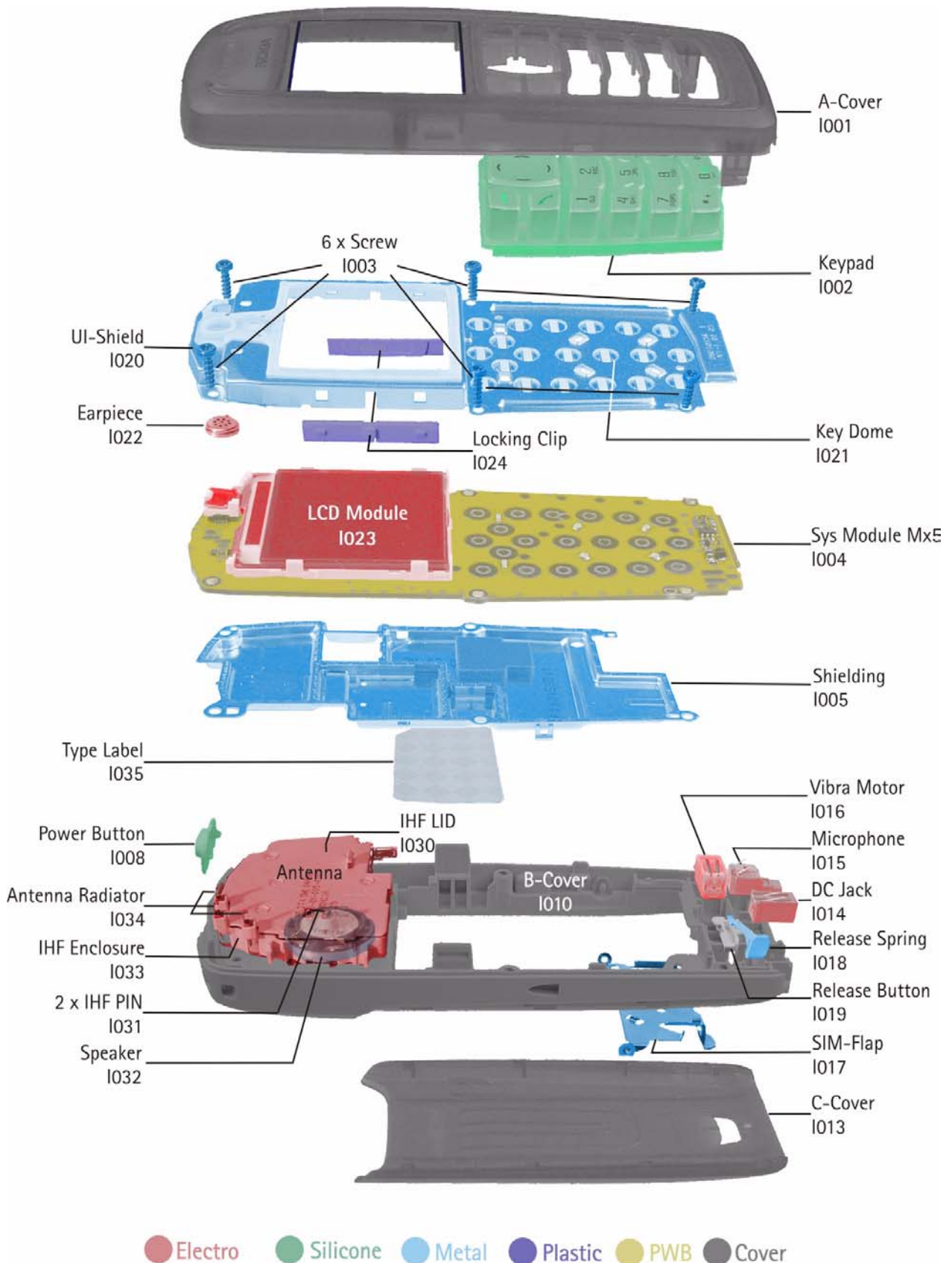

Assembly Parts List

Item	Description	RH-19	RH-50	PWB Item
I001	A-cover assy DMC06433, white (RH-19)	9459929		
	A-cover assy AWS DMC07036, blue (RH-50)		9491693	
I002	Keypad latin DMC06505 (RH-19)	9791085		
	Keypad latin AWS DMC07756 (RH-50)		9792021	
I003	Screw RF 1,8x6 DMD06930		6290119	
I004	PWB MX5		xxxxxxx	
I012	BR-5C Battery Pack DMC10417		xxxxxxx	
I013	C-cover DMD10532, white (RH-19)	9453352		
	C-cover AWS, DMC07113, blue (RH-50)		9459396	
	B-cover assembly DMC06434 (RH-19)	9453312		
	B-cover assembly DMC07092 (RH-50)		9459370	
I005	Shielding assembly DMC04605		9510919	
I008	Power button DMD10533		9453311	
I010	B-Cover DMD10531		9453273	
I014	DC-plug DNS04930		5400243	X102
I015	Microphone DNC05371		5140265	B101
I016	Vib motor assy		6800069	M300
I017	SIM-flap DMD08487		9560199	
I018	C-cover release spring DMD08481		9510935	
I019	C-cover release button DMD10535		9453272	
	UI module DMC06354		9498010	
	UI-shield key dome assy HDG12		9491669	
I020	UI-shield assy DMC06295		xxxxxxx	
I021	Key dome assy DMC06521		xxxxxxx	
I022	Speaker pico DNS04636		5140251	B300
I023	LCD module		xxxxxxx	
I024	Locking clip DMD08699		xxxxxxx	
	Antenna assy DMC04605 (RH-19)	0660266		
	Antenna assy DMC07129 (RH-50)		0660302	
I030	IHF lid DMD08493		xxxxxxx	
I031	IHF pin DMD08352 NHL-4		xxxxxxx	

Item	Description	RH-19	RH-50	PWB Item
I032	IHF speaker DNS05333	xxxxxxx		B301
I033	IHF enclosure DMD08492	xxxxxxx		
I034	Antenna radiator DMD08497	xxxxxxx		
I035	Type Label	Various		

Parts List PWB Module for RH-19/RH-50

PWB Mx7 Components

Item	Product Code	Location				Description and value			Type	RH-19, HWID				RH-50
		Side & Grid ref.		27 01	27 02					27 03	27 04			
B200	4510303	Bot- tom	M			6	CRYSTAL 32.768KHZ +-30PPM 9PF	32.768kHz	~			CRYSTAL_CX_4V		
B601	4510337	Bot- tom	H	3	CRYSTAL 26.0MHZ +-8PPM CL=15.5	26MHz	~	CRYSTAL_TSX_8A						
C100	2320546	Bot- tom	F	8	Chipcap 5% NPO	27p 50V	normal,-5%,5%	0402C						
C101	2320481	Top	T	6	CHIPCAP X5R 1U K 6V3	1u0 6.3V	normal,-10%,10%	0603C						
C102	2320481	Top	T	8	CHIPCAP X5R 1U K 6V3	1u0 6.3V	normal,-10%,10%	0603C						
C103	2321013	Bot- tom	R	8	CHIPCAP NPO 270P J 25V	270p 25V	normal,-5%,5%	0402C						
C104	2320544	Bot- tom	R	8	Chipcap 5% NPO	22p 50V	normal,-5%,5%	0402C						
C105	2320544	Bot- tom	R	7	Chipcap 5% NPO	22p 50V	normal,-5%,5%	0402C						
C106	2320744	Top	T	6	Chipcap X7R 10% 50V	1n0 50V	normal,-10%,10%	0402C						
C107	2320778	Top	T	8	Chipcap X7R 10% 16V	10n 16V	normal,-10%,10%	0402C						
C108	2320778	Top	T	7	Chipcap X7R 10% 16V	10n 16V	normal,-10%,10%	0402C						
C109	2320778	Top	T	8	Chipcap X7R 10% 16V	10n 16V	normal,-10%,10%	0402C						
C110	2320544	Top	T	6	Chipcap 5% NPO	22p 50V	normal,-5%,5%	0402C						
C111	2320778	Top	T	8	Chipcap X7R 10% 16V	10n 16V	normal,-10%,10%	0402C						
C113	2320778	Top	T	7	Chipcap X7R 10% 16V	10n 16V	normal,-10%,10%	0402C						
C150	2320481	Bot- tom	O	7	CHIPCAP X5R 1U K 6V3	1u0 6.3V	normal,-10%,10%	0603C						
C151	2320744	Bot- tom	O	7	Chipcap X7R 10% 50V	1n0 50V	normal,-10%,10%	0402C						
C152	2320481	Bot- tom	O	7	CHIPCAP X5R 1U K 6V3	1u0 6.3V	normal,-10%,10%	0603C						
C153	2320783	Bot- tom	N	7	CHIPCAP X7R 33N K 10V	33n 10V	normal,-20%,20%	0402C						
C154	2320544	Bot- tom	S	4	Chipcap 5% NPO	22p 50V	normal,-5%,5%	0402C						
C155	2320783	Bot- tom	N	6	CHIPCAP X7R 33N K 10V	33n 10V	normal,-10%,10%	0402C						
C156	2320544	Top	T	8	Chipcap 5% NPO	22p 50V	normal,-10%,10%	0402C						
C157	2320544	Top	T	8	Chipcap 5% NPO	22p 50V	normal,-10%,10%	0402C						
C158	2320805	Bot- tom	N	7	CHIPCAP X5R 100N K 10V	100n 10V	normal,-10%,10%	0402C						

Item	Product Code	Location			Description and value	Type	RH-19, HWID				RH-50		
		Side	Et	Grid ref.			27 01	27 02	27 03	27 04			
C159	2320783	Bot- tom	N	7	CHIPCAP X7R 33N K 10V	33n 10V	normal,-20%,20%	0402C					
C160	2320544	Bot- tom	N	7	Chipcap 5% NPO	22p 50V	normal,-5%,5%	0402C					
C161	2320744	Bot- tom	N	7	Chipcap X7R 10% 50V	1n0 50V	normal,-10%,10%	0402C					
C162	2320805	Bot- tom	N	7	CHIPCAP X5R 100N K 10V	100n 10V	normal,-10%,10%	0402C					
C163	2320481	Bot- tom	O	7	CHIPCAP X5R 1U K 6V3	1u0 6.3V	normal,-10%,10%	0603C					
C164	2320544	Bot- tom	N	6	Chipcap 5% NPO	22p 50V	normal,-5%,5%	0402C					
C165	2320544	Bot- tom	N	6	Chipcap 5% NPO	22p 50V	normal,-5%,5%	0402C					
C166	2320783	Bot- tom	O	8	CHIPCAP X7R 33N K 10V	33n 10V	normal,-20%,20%	0402C					
C167	2320481	Bot- tom	O	6	CHIPCAP X5R 1U K 6V3	1u0 6.3V	normal,-10%,10%	0603C					
C168	2320805	Bot- tom	O	6	CHIPCAP X5R 100N K 10V	100n 10V	normal,-10%,10%	0402C					
C169	2320544	Bot- tom	O	6	Chipcap 5% NPO	22p 50V	normal,-5%,5%	0402C					
C170	2320783	Bot- tom	N	8	CHIPCAP X7R 33N K 10V	33n 10V	normal,-20%,20%	0402C					
C171	2320744	Bot- tom	N	7	Chipcap X7R 10% 50V	1n0 50V	normal,-10%,10%	0402C					
C172	2320744	Bot- tom	N	8	Chipcap X7R 10% 50V	1n0 50V	normal,-10%,10%	0402C					
C173	2320744	Bot- tom	N	8	Chipcap X7R 10% 50V	1n0 50V	normal,-10%,10%	0402C					
C174	2320744	Bot- tom	O	8	Chipcap X7R 10% 50V	1n0 50V	normal,-10%,10%	0402C					
C175	2320481	Bot- tom	O	8	CHIPCAP X5R 1U K 6V3	1u0 6.3V	normal,-10%,10%	0603C					
C176	2320481	Bot- tom	O	8	CHIPCAP X5R 1U K 6V3	1u0 6.3V	normal,-10%,10%	0603C					
C177	2320552	Bot- tom	E	3	Chipcap 5% NPO	47p 50V	normal,-5%,5%	0402C					
C178	2320552	Bot- tom	E	3	Chipcap 5% NPO	47p 50V	normal,-5%,5%	0402C					
C179	2320544	Bot- tom	M	6	Chipcap 5% NPO	22p 50V	normal,-5%,5%	0402C					
C180	2320544	Bot- tom	M	6	Chipcap 5% NPO	22p 50V	normal,-5%,5%	0402C					

Item	Product Code	Location			Description and value	Type	RH-19, HWID				RH-50	
		Side	Et	Grid ref.			27 01	27 02	27 03	27 04		
C181	2320544	Bot- tom	O	8	Chipcap 5% NP0 22p 50V	normal,-5%,5%	0402C					
C182	2320544	Bot- tom	O	8	Chipcap 5% NP0 22p 50V	normal,-5%,5%	0402C					
C183	2320481	Bot- tom	O	8	CHIPCAP X5R 1U K 6V3 1u0 6.3V	normal,-10%,10%	0603C	NA	NA	NA	NA	NA
C185	2320744	Bot- tom	N	7	Chipcap X7R 10% 50V 1n0 50V	normal,-10%,10%	0402C					
C186	2320481	Bot- tom	O	7	CHIPCAP X5R 1U K 6V3 1u0 6.3V	normal,-10%,10%	0603C	NA	NA	NA	NA	NA
C187	2320744	Bot- tom	N	7	Chipcap X7R 10% 50V 1n0 50V	normal,-10%,10%	0402C					
C200	2320805	Bot- tom	L	7	CHIPCAP X5R 100N K 10V	normal,-10%,10%	0402C					
C201	2320481	Bot- tom	K	6	CHIPCAP X5R 1U K 6V3 1u0 6.3V	normal,-10%,10%	0603C					
C202	2320778	Bot- tom	K	6	Chipcap X7R 10% 16V 10n 16V	normal,-10%,10%	0402C					
C203	2320481	Bot- tom	N	9	CHIPCAP X5R 1U K 6V3 1u0 6.3V	normal,-10%,10%	0603C					
C204	2320481	Bot- tom	K	6	CHIPCAP X5R 1U K 6V3 1u0 6.3V	normal,-10%,10%	0603C					
C205	2320481	Bot- tom	L	6	CHIPCAP X5R 1U K 6V3 1u0 6.3V	normal,-10%,10%	0603C					
C206	2320481	Bot- tom	L	6	CHIPCAP X5R 1U K 6V3 1u0 6.3V	normal,-10%,10%	0603C					
C207	2320481	Bot- tom	M	9	CHIPCAP X5R 1U K 6V3 1u0 6.3V	normal,-10%,10%	0603C					
C208	2320481	Bot- tom	K	6	CHIPCAP X5R 1U K 6V3 1u0 6.3V	normal,-10%,10%	0603C					
C209	2320536	Bot- tom	M	6	Chipcap 5% NP0 10p 50V	normal,-5%,5%	0402C					
C210	2320536	Bot- tom	N	6	Chipcap 5% NP0 10p 50V	normal,-5%,5%	0402C					
C211	2320481	Bot- tom	M	6	CHIPCAP X5R 1U K 6V3 0603	normal,-10%,10%	0603C					
C212	2320481	Bot- tom	P	6	CHIPCAP X5R 1U K 6V3 0603	normal,-10%,10%	0603C					
C213	2320481	Bot- tom	L	6	CHIPCAP X5R 1U K 6V3 0603	normal,-10%,10%	0603C					
C214	2320481	Bot- tom	L	6	CHIPCAP X5R 1U K 6V3 0603	normal,-10%,10%	0603C					
C215	2320481	Bot- tom	N	8	CHIPCAP X5R 1U K 6V3 1u0 6.3V	normal,-10%,10%	0603C					

Item	Product Code	Location			Description and value	Type	RH-19, HWID				RH-50		
		Side	Et	Grid ref.			27 01	27 02	27 03	27 04			
C218	2320805	Bot- tom	K	9	CHIPCAP X5R 100N K 10V	100n 10V	normal,-10%,10%	0402C					
C219	2320481	Bot- tom	K	7	CHIPCAP X5R 1U K 6V3	1u0 6.3V	normal,-10%,10%	0603C					
C220	2320778	Bot- tom	N	6	Chipcap X7R 10% 16V	10n 16V	normal,-10%,10%	0402C					
C221	2320481	Bot- tom	K	7	CHIPCAP X5R 1U K 6V3	1u0 6.3V	normal,-10%,10%	0603C					
C222	2320481	Bot- tom	J	7	CHIPCAP X5R 1U K 6V3	1u0 6.3V	normal,-10%,10%	0603C					
C223	2320481	Bot- tom	K	7	CHIPCAP X5R 1U K 6V3	1u0 6.3V	normal,-10%,10%	0603C					
C224	2320481	Bot- tom	K	8	CHIPCAP X5R 1U K 6V3	1u0 6.3V	normal,-10%,10%	0603C					
C225	2320481	Bot- tom	K	8	CHIPCAP X5R 1U K 6V3	1u0 6.3V	normal,-10%,10%	0603C					
C226	2320481	Bot- tom	J	8	CHIPCAP X5R 1U K 6V3	1u0 6.3V	normal,-10%,10%	0603C					
C227	2320481	Bot- tom	J	8	CHIPCAP X5R 1U K 6V3	1u0 6.3V	normal,-10%,10%	0603C					
C228	2320481	Bot- tom	J	9	CHIPCAP X5R 1U K 6V3	1u0 6.3V	normal,-10%,10%	0603C					
C229	2320481	Bot- tom	J	8	CHIPCAP X5R 1U K 6V3	1u0 6.3V	normal,-10%,10%	0603C					
C230	2320481	Bot- tom	K	8	CHIPCAP X5R 1U K 6V3	1u0 6.3V	normal,-10%,10%	0603C					
C231	2320481	Bot- tom	K	9	CHIPCAP X5R 1U K 6V3	1u0 6.3V	normal,-10%,10%	0603C					
C232	2320481	Bot- tom	K	8	CHIPCAP X5R 1U K 6V3	1u0 6.3V	normal,-10%,10%	0603C					
C234	2320481	Bot- tom	J	8	CHIPCAP X5R 1U K 6V3	1u0 6.3V	normal,-10%,10%	0603C					
C235	2320481	Bot- tom	K	9	CHIPCAP X5R 1U K 6V3	1u0 6.3V	normal,-10%,10%	0603C					
C236	2320805	Bot- tom	K	9	CHIPCAP X5R 100N K 10V	100n 10V	normal,-10%,10%	0402C					
C237	2320805	Bot- tom	M	7	CHIPCAP X5R 100N K 10V	100n 10V	normal,-10%,10%	0402C					
C238	2320805	Bot- tom	L	6	CHIPCAP X5R 100N K 10V	100n 10V	normal,-10%,10%	0402C					
C239	2320805	Bot- tom	L	9	CHIPCAP X5R 100N K 10V	100n 10V	normal,-10%,10%	0402C					
C240	2320778	Bot- tom	L	1 0	Chipcap X7R 10% 16V	10n 16V	normal,-10%,10%	0402C					

Item	Product Code	Location				Description and value	Type	RH-19, HWID				RH-50	
		Side	Et	Grid	ref.			27 01	27 02	27 03	27 04		
C241	2320744	Bot- tom	M	6	Chipcap X7R 10% 50V	1n0 50V	normal,-10%,10%	0402C					
C242	2320744	Bot- tom	L	9	Chipcap X7R 10% 50V	1n0 50V	normal,-10%,10%	0402C	NA	NA	NA	NA	NA
C243	2320481	Bot- tom	M	6	CHIPCAP X5R 1U K 6V3	1u0 6.3V	normal,-10%,10%	0603C					
C260	2320481	Bot- tom	J	8	CHIPCAP X5R 1U K 6V3	1u0 6.3V	normal,-10%,10%	0603C					
C261	2320481	Bot- tom	K	6	CHIPCAP X5R 1U K 6V3	1u0 6.3V	normal,-10%,10%	0603C					
C262	2320481	Bot- tom	J	7	CHIPCAP X5R 1U K 6V3	1u0 6.3V	normal,-10%,10%	0603C					
C263	2320481	Bot- tom	J	8	CHIPCAP X5R 1U K 6V3	1u0 6.3V	normal,-10%,10%	0603C					
C264	2320481	Bot- tom	J	8	CHIPCAP X5R 1U K 6V3	1u0 6.3V	normal,-10%,10%	0603C					
C265	2320481	Bot- tom	J	8	CHIPCAP X5R 1U K 6V3	1u0 6.3V	normal,-10%,10%	0603C					
C302	2320556	Bot- tom	O	9	Chipcap 5% NPO	68p 50V	normal,-5%,5%	0402C					
C303	2320481	Bot- tom	O	9	CHIPCAP X5R 1U K 6V3	1u0 6.3V	normal,-10%,10%	0603C					
C304	2312411	Bot- tom	M	9	CHIPCAP X5R 1U0 M 25V	1u0 25V	normal,-20%,20%	1206_BLM					
C306	2320778	Bot- tom	Q	6	Chipcap X7R 10% 16V	10n 16V	normal,-10%,10%	0402C					
C310	2320544	Bot- tom	B	6	Chipcap 5% NPO	22p 50V	normal,-5%,5%	0402C					
C312	2320544	Bot- tom	F	3	Chipcap 5% NPO	22p 50V	normal,-5%,5%	0402C					
C313	2320544	Top	B	5	Chipcap 5% NPO	22p 50V	normal,-5%,5%	0402C					
C315	2320544	Bot- tom	R	5	Chipcap 5% NPO	22p 50V	normal,-5%,5%	0402C	NA	NA	NA	NA	
C316	2320481	Bot- tom	R	4	CHIPCAP X5R 1U K 6V3 0603	1u0 6.3V	normal,-10%,10%	0603C					
C319	2320805	Bot- tom	O	6	CHIPCAP X5R 100N K 10V 0402	100n 10V	normal,-10%,10%	0402C					
C322	2320552	Bot- tom	K	9	Chipcap 5% NPO	47p 50V	normal,-5%,5%	0402C	NA	NA	NA	NA	NA
C330	2320552	Bot- tom	N	9	Chipcap 5% NPO	47p 50V	normal,-5%,5%	0402C	NA	NA	NA	NA	NA
C331	2320552	Bot- tom	N	9	Chipcap 5% NPO	47p 50V	normal,-5%,5%	0402C	NA	NA	NA	NA	NA

Item	Product Code	Location			Description and value	Type	RH-19, HWID				RH-50		
		Side	Et	Grid ref.			27 01	27 02	27 03	27 04			
C390	2320805	Bot- tom	R	9	CHIPCAP X5R 100N K 10V	100n 10V	normal,-10%,10%	0402C					
C391	2320552	Bot- tom	R	9	Chipcap 5% NPO	47p 50V	normal,-5%,5%	0402C					
C392	2320552	Bot- tom	O	7	Chipcap 5% NPO	47p 50V	normal,-5%,5%	0402C	X	X	X	X	
	2320536	Bot- tom	O	7	Chipcap 5% NPO	10p 50V	normal,-5%,5%	0402C					X
C393	2320544	Bot- tom	O	8	Chipcap 5% NPO	22p 50V	normal,-5%,5%	0402C	NA	NA	NA	NA	NA
C400	2320778	Bot- tom	M	6	Chipcap X7R 10% 16V	10n 16V	normal,-10%,10%	0402C					
C401	2320805	Bot- tom	M	6	CHIPCAP X5R 100N K 10V	100n 10V	normal,-10%,10%	0402C					
C402	2320778	Bot- tom	L	6	Chipcap X7R 10% 16V	10n 16V	normal,-10%,10%	0402C					
C403	2320778	Bot- tom	N	6	Chipcap X7R 10% 16V	10n 16V	normal,-10%,10%	0402C					
C404	2320778	Bot- tom	N	6	Chipcap X7R 10% 16V	10n 16V	normal,-10%,10%	0402C					
C405	2320778	Bot- tom	N	6	Chipcap X7R 10% 16V	10n 16V	normal,-10%,10%	0402C					
C420	2320552	Bot- tom	L	6	Chipcap 5% NPO	47p 50V	normal,-5%,5%	0402C					
C426	2320744	Bot- tom	K	6	Chipcap X7R 10% 50V	1n0 50V	normal,-10%,10%	0402C					
C450	2320778	Bot- tom	Q	6	Chipcap X7R 10% 16V	10n 16V	normal,-10%,10%	0402C					
C451	2320805	Bot- tom	Q	6	CHIPCAP X5R 100N K 10V	100n 10V	normal,-10%,10%	0402C					
C454	2320779	Bot- tom	P	6	CHIPCAP X7R 100N K 16V	100n 16V	normal,-10%,10%	0603_BLM					
C601	2320629	Bot- tom	C	5	CHIPCAP NPO 1P0 B 50V	1p0 50V	normal,-0.1p,0.1p	0402C					
C602	2320629	Bot- tom	C	4	CHIPCAP NPO 1P0 B 50V	1p0 50V	normal,-0.1p,0.1p	0402C					
C603	2320744	Bot- tom	H	4	Chipcap X7R 10% 50V	1n0 50V	normal,-10%,10%	0402C					
C605	2320805	Bot- tom	I	4	CHIPCAP X5R 100N K 10V	100n 10V	normal,-10%,10%	0402C					
C606	2320546	Bot- tom	H	4	Chipcap 5% NPO	27p 50V	normal,-5%,5%	0402C					
C607	2312211	Bot- tom	G	3	CHIPCAP X5R 3U3 K 6V3	3u3 6V3	normal,-10%,10%	0805C_H1.35					

Item	Product Code	Location			Description and value	Type	RH-19, HWID				RH-50		
		Side	Et	Grid ref.			27 01	27 02	27 03	27 04			
C610	2320805	Bot- tom	L	5	CHIPCAP X5R 100N K 10V	100n 10V	normal,-10%,10%	0402C					
C611	2320516	Bot- tom	D	5	Chipcap +-0.25pF NPO	1p5 50V	normal,-0.25pF,0.25pF	0402C	NA	NA	NA	NA	NA
C615	2320778	Bot- tom	H	4	Chipcap X7R 10% 16V	10n 16V	normal,-10%,10%	0402C					
C620	2320546	Bot- tom	G	4	Chipcap 5% NPO	27p 50V	normal,-5%,5%	0402C					
C621	2320552	Bot- tom	I	3	Chipcap 5% NPO	47p 50V	normal,-5%,5%	0402C					
C622	2320805	Bot- tom	I	4	CHIPCAP X5R 100N K 10V	100n 10V	normal,-10%,10%	0402C					
C623	2320805	Bot- tom	I	5	CHIPCAP X5R 100N K 10V	100n 10V	normal,-10%,10%	0402C					
C624	2320546	Bot- tom	H	6	Chipcap 5% NPO	27p 50V	normal,-5%,5%	0402C					
C625	2320481	Bot- tom	J	5	CHIPCAP X5R 1U K 6V3	1u0 6.3V	normal,-10%,10%	0603C					
C626	2320522	Bot- tom	G	6	Chipcap +-0.25pF NPO	2p7 50V	normal,-0.25pF,0.25pF	0402C					
C627	2313213	Bot- tom	J	3	CHIPCAP X5R 10U K 6V3	10u 6.3V	normal,-10%,10%	1206C_H1.8					
C628	2320778	Bot- tom	I	4	Chipcap X7R 10% 16V	10n 16V	normal,-10%,10%	0402C					
C629	2320546	Bot- tom	I	5	Chipcap 5% NPO	27p 50V	normal,-5%,5%	0402C					
C630	2320629	Bot- tom	G	5	CHIPCAP NPO 1P0 B 50V	1p0 50V	normal,-0.1p,0.1p	0402C					
C631	2320629	Bot- tom	G	6	CHIPCAP NPO 1P0 B 50V	1p0 50V	normal,-0.1p,0.1p	0402C					
C632	2320805	Bot- tom	H	4	CHIPCAP X5R 100N K 10V	100n 10V	normal,-10%,10%	0402C					
C633	2320546	Bot- tom	I	5	Chipcap 5% NPO	27p 50V	normal,-5%,5%	0402C					
C634	2320522	Bot- tom	G	4	Chipcap +-0.25pF NPO	2p7 50V	normal,-0.25pF,0.25pF	0402C	X	X	X	X	
	2320516	Bot- tom	G	4	Chipcap +-0.25pF NPO	1p5	normal,-0.25pF,0.25pF	0402C					X
C635	2320546	Bot- tom	I	5	Chipcap 5% NPO	27p 50V	normal,-5%,5%	0402C					
C636	2320778	Bot- tom	I	4	Chipcap X7R 10% 16V	10n 16V	normal,-10%,10%	0402C					
C637	2320778	Bot- tom	I	5	Chipcap X7R 10% 16V	10n 16V	normal,-10%,10%	0402C					

Item	Product Code	Location				Description and value	Type	RH-19, HWID				RH-50	
		Side	Et	Grid	ref.			27 01	27 02	27 03	27 04		
C638	2320805	Bot- tom	H	6	CHIPCAP X5R 100N K 10V	100n 10V	normal,-10%,10%	0402C	NA	NA	NA	NA	NA
C639	2320805	Bot- tom	I	5	CHIPCAP X5R 100N K 10V	100n 10V	normal,-10%,10%	0402C	NA	NA	NA	NA	NA
C701	2320532	Bot- tom	D	4	Chipcap +-0.25pF NPO	6p8 50V	normal,-0.25pF,0.25pF	0402C					
C702	2320532	Bot- tom	E	5	Chipcap +-0.25pF NPO	6p8 50V	normal,-0.25pF,0.25pF	0402C					
C703	2320546	Bot- tom	D	5	Chipcap 5% NPO	27p 50V	normal,-5%,5%	0402C					
C705	2322023	Bot- tom	I	6	CHIPCAP NPO 2N2 J 16V	2n2 16V	normal,-5%,5%	0603C					
C706	2320556	Bot- tom	I	6	Chipcap 5% NPO	68p 50V	normal,-5%,5%	0402C					
C709	2320631	Bot- tom	I	6	CHIPCAP NPO 180P J 25V	180p 25V	normal,-5%,5%	0402C					
C710	2320631	Bot- tom	I	5	CHIPCAP NPO 180P J 25V	180p 25V	normal,-5%,5%	0402C					
C711	2310055	Bot- tom	J	6	CHIPCAP NPO 3N9 J 25V	3n9 25V	normal,-5%,5%	0805C_AVX					
C712	2320631	Bot- tom	K	3	CHIPCAP NPO 180P J 25V	180p 25V	normal,-5%,5%	0402C					
C715	2320556	Bot- tom	I	5	Chipcap 5% NPO	68p 50V	normal,-5%,5%	0402C					
C716	2320556	Bot- tom	I	4	Chipcap 5% NPO	68p 50V	normal,-5%,5%	0402C					
C717	2320546	Bot- tom	J	6	Chipcap 5% NPO	27p 50V	normal,-5%,5%	0402C					
C718	2320744	Bot- tom	I	6	Chipcap X7R 10% 50V	1n0 50V	normal,-10%,10%	0402C					
C720	2320635	Bot- tom	G	6	CHIPCAP NPO 0P5 C 50V	0p5 50V	normal,-0.25p,0.25p	0402C	NA	NA	NA	NA	NA
C721	2320744	Bot- tom	G	6	Chipcap X7R 10% 50V	1n0 50V	normal,-10%,10%	0402C					
C722	2320540	Bot- tom	F	6	Chipcap 5% NPO	15p 50V	normal,-5%,5%	0402C					
C723	2320540	Bot- tom	F	6	Chipcap 5% NPO	15p 50V	normal,-5%,5%	0402C					
C724	2320151	Bot- tom	F	6	Chipcap NPO 2P7 B 50V	2p7 50V	normal,-0.1p,0.1p	0402C	NA	NA	NA	NA	NA
C731	2320550	Bot- tom	G	6	Chipcap 5% NPO	39p 50V	normal,-5%,5%	0402C					
C734	2320524	Bot- tom	I	6	Chipcap +-0.25pF NPO	3p3 50V	normal,-0.25pF,0.25pF	0402C	NA	NA	NA	NA	NA

Item	Product Code	Location			Description and value	Type	RH-19, HWID				RH-50		
		Side	Et	Grid ref.			27 01	27 02	27 03	27 04			
C740	2312211	Bot- tom	K	5	CHIPCAP X5R 3U3 K 6V3	3u3 6V3	normal,-10%,10%	0805C_H1.35					
C741	2320635	Bot- tom	K	3	CHIPCAP NPO 0P5 C 50V	0p5 50V	normal,-0.25p,0.25p	0402C					
C742	2320532	Bot- tom	L	3	Chipcap +-0.25pF NPO	6p8 50V	normal,-0.25pF,0.25pF	0402C					
C801	2320602	Bot- tom	E	6	Chipcap +-0.25pF NPO	4p7 50V	normal,-0.25pF,0.25pF	0402C					
C802	2320546	Bot- tom	D	6	Chipcap 5% NPO	27p 50V	normal,-5%,5%	0402C					
C803	2320546	Bot- tom	C	5	Chipcap 5% NPO	27p 50V	normal,-5%,5%	0402C					
C804	2320546	Bot- tom	C	5	Chipcap 5% NPO	27p 50V	normal,-5%,5%	0402C					
C805	2320546	Bot- tom	C	5	Chipcap 5% NPO	27p 50V	normal,-5%,5%	0402C					
C807	2320520	Bot- tom	C	6	Chipcap +-0.25pF NPO	2p2 50V	normal,-0.25pF,0.25pF	0402C					
C810	2320602	Bot- tom	E	6	Chipcap +-0.25pF NPO	4p7 50V	normal,-0.25pF,0.25pF	0402C	NA	NA	NA	NA	NA
C811	2320744	Bot- tom	C	6	Chipcap X7R 10% 50V	1n0 50V	normal,-10%,10%	0402C					
C812	2310793	Bot- tom	I	9	CHIPCAP X5R 2U2 K 10V	2u2 10V	normal,-10%,10%	0805C					
C813	2320524	Bot- tom	D	6	Chipcap +-0.25pF NPO	3p3 50V	normal,-0.25pF,0.25pF	0402C					
C814	2320548	Bot- tom	C	6	Chipcap 5% NPO	33p 50V	normal,-5%,5%	0402C					
C815	2611753	Bot- tom	I	8	CHIPTCAP 33U M 16V 6.0X3.2X1.5	33u 16V	normal,-20%,20%	TANT_TPSW2					
C816	2320604	Bot- tom	I	9	Chipcap 5% NPO	18p 50V	normal,-5%,5%	0402C					
C817	2320602	Bot- tom	I	9	Chipcap +-0.25pF NPO	4p7 50V	normal,-0.25pF,0.25pF	0402C					
C818	2320546	Bot- tom	D	9	Chipcap 5% NPO	27p 50V	normal,-5%,5%	0402C					
C819	2611753	Bot- tom	B	8	CHIPTCAP 33U M 16V 6.0X3.2X1.5	33u 16V	normal,-20%,20%	TANT_TPSW2					
C820	2320546	Bot- tom	D	9	Chipcap 5% NPO	27p 50V	normal,-5%,5%	0402C	X	X	X	X	
	2320602	Bot- tom	D	9	Chipcap 5% NPO	4p7 50V	normal,-5%,5%	0402C					X

Item	Product Code	Location			Description and value	Type	RH-19, HWID				RH-50	
		Side	Et	Grid ref.			27 01	27 02	27 03	27 04		
C821	2320518	Bot- tom	D	9	Chipcap +-0.25pF NPO 1p8 50V	normal,- 0.25pF,0.25pF	0402C	X	X	X	X	
	2320516	Bot- tom	D	9	Chipcap +-0.25pF NPO 1p5 50V	normal,- 0.25pF,0.25pF	0402C					X
C822	2320546	Bot- tom	E	9	Chipcap 5% NPO 27p 50V	normal,-5%,5%	0402C					
C823	2320518	Bot- tom	E	6	Chipcap +-0.25pF NPO 1p8 50V	normal,- 0.25pF,0.25pF	0402C	NA	NA	NA	NA	NA
C824	2320526	Bot- tom	E	9	Chipcap +-0.25pF NPO 3p9 50V	normal,- 0.25pF,0.25pF	0402C					
C825	2320805	Bot- tom	E	6	CHIPCAP X5R 100N K 10V	normal,-10%,10%	0402C					
C826	2320805	Bot- tom	C	6	CHIPCAP X5R 100N K 10V	normal,-10%,10%	0402C					
C830	2320787	Bot- tom	C	9	CHIPCAP X7R 15N K 16V	normal,-10%,10%	0402C	NA	NA	NA	NA	NA
C832	2320787	Bot- tom	E	9	CHIPCAP X7R 15N K 16V	normal,-10%,10%	0402C	NA	NA	NA	NA	NA
C835	2320514	Bot- tom	F	9	Chipcap +-0.25pF NPO 1p2 50V	normal,- 0.25pF,0.25pF	0402C					
C836	2320524	Bot- tom	F	8	Chipcap +-0.25pF NPO 3p3 50V	normal,- 0.25pF,0.25pF	0402C					
C837	2320552	Bot- tom	F	8	Chipcap 5% NPO 47p 50V	normal,-5%,5%	0402C					
C872	2320805	Bot- tom	H	3	CHIPCAP X5R 100N K 10V 0402	normal,-10%,10%	0402C					
D200	4376001	Bot- tom	L	8	UEMK W-DOG ENA TO21 TFBGA168	~	~	uBGA168	X	X	X	X
	4370959	Bot- tom	L	8	UEMK Edge WDNA TO25 TFBGA168	~	~	uBGA168				X
D400	4370931	Bot- tom	N	4	UPP8M V2.2 F751986B C035	~	~	uBGA144_CC	X	X	X	X
	4375019	Bot- tom	N	4	UPP8M V3.5 F751542I C035	~	~	uBGA144_CC				X
D450	4341531	Bot- tom	P	4	COMBO 64M NOR+4M SRAM TBGA48	4Mx16/ 256kx16	~	COMBO_64MB_SI				
F100	5119019	Top	T	5	SM FUSE F 1.5A 32V 0603	1.5A	~	0603_FUSE				
G701	4350315	Bot- tom	K	4	VCO 3420-3980MHZ 2.7V 19MA	3420- 3980MHz	~	VCO_FDK_IT_H1.7	X		X	
	4350421	Bot- tom	K	4	VCO 3420-3980MHZ 2.7V 20MA GSM	3420- 3980MHz	~	VCO_Matsushita_E NFVJ5W2S05		X		X
	4350391	Bot- tom	K	4	VCO 3296-3980 MHz 2.7V 20 MA GSM	3296- 3980MHz	~	VCO_Matsushita_E ENFVZ6P28				X

Item	Product Code	Location			Description and value	Type	RH-19, HWID				RH-50		
		Side	Et	Grid ref.			27 01	27 02	27 03	27 04			
L100	3203705	Top	T	5	FERRITE BEAD 42R/ 100MHZ 0805	42R/ 100MHz	~						
L102	3203803	Top	T	7	CHIP BEAD ARRAY 2X1000R 0405	2x1000R/ 100MHz	-						
L103	3203803	Top	T	8	CHIP BEAD ARRAY 2X1000R 0405	2x1000R/ 100MHz	-						
L106	3203725	Top	T	6	FERRITE BEAD 0R6 600R/100M 0402	600R/ 100MHz	~						
L107	3203741	Top	T	6	FERRITE BEAD 0R5 600R/100MHZ 0603	600R/ 100MHz	~						
L150	3203803	Top	B	5	CHIP BEAD ARRAY 2X1000R 0405	2x1000R/ 100MHz	-						
L151	3203769	Bot- tom	E	3	FERR.BEAD 240R7100M 0.4A 0R4 0402	240R/ 100MHz	~						
L152	3203769	Bot- tom	E	3	FERR.BEAD 240R7100M 0.4A 0R4 0402	240R/ 100MHz	~						
L153	3203725	Bot- tom	S	4	FERRITE BEAD 0R6 600R/100M 0402	600R/ 100MHz	~						
L260	3203741	Bot- tom	I	8	FERRITE BEAD 0R5 600R/100MHZ 0603	600R/ 100MHz	~						
L261	3203741	Bot- tom	K	6	FERRITE BEAD 0R5 600R/100MHZ 0603	600R/ 100MHz	~						
L262	3203741	Bot- tom	I	7	FERRITE BEAD 0R5 600R/100MHZ 0603	600R/ 100MHz	~						
L263	3203741	Bot- tom	I	8	FERRITE BEAD 0R5 600R/100MHZ 0603	600R/ 100MHz	~						
L264	3203741	Bot- tom	I	8	FERRITE BEAD 0R5 600R/100MHZ 0603	600R/ 100MHz	~						
L265	3203741	Bot- tom	I	8	FERRITE BEAD 0R5 600R/100MHZ 0603	600R/ 100MHz	~						
L300	3640119	Bot- tom	N	8	CHOKE 22U M 1R4 0.33A 3.3X3.3X1.5	22uH	normal,-20%,20%						
L301	3203725	Bot- tom	R	5	FERRITE BEAD 0R6 600R/100M 0402	600R/ 100MHz	~						
L302	3203741	Bot- tom	R	5	FERRITE BEAD 0R5 600R/100MHZ 0603	600R/ 100MHz	~						
L303	3203725	Bot- tom	R	8	FERRITE BEAD 0R6 600R/100M 0402	600R/ 100MHz	~						
L601	3646087	Bot- tom	G	5	CHIP COIL 1N8+-0N3 Q31/800M 0402	1n8H	normal,-0n3,0n3						
L602	3646087	Bot- tom	G	5	CHIP COIL 1N8+-0N3 Q31/800M 0402	1n8H	normal,-0n3,0n3						
L603	3646005	Bot- tom	G	5	CHIP COIL 2N7+-0N3 Q29/800M 0402	2n7H	normal,-0n3,0n3						

Item	Product Code	Location			Description and value	Type	RH-19, HWID				RH-50		
		Side	Et	Grid ref.			27 01	27 02	27 03	27 04			
L604	3646005	Bot- tom	G	5	CHIP COIL 2N7+-0N3 Q29/800M 0402	2n7H	normal,-0n3,0n3	0402L					
L606	3646055	Bot- tom	G	5	CHIP COIL 8N2 J Q28/ 800MHZ 0402	8n2H	normal,-5%,+5%	0402L	X	X	X	X	
	3646009	Bot- tom	G	5	CHIP COIL10N J Q28/ 800MHZ 0402	10N 10nH	normal,-5%,+5%	0402L					X
L607	3646055	Bot- tom	G	4	CHIP COIL 8N2 J Q28/ 800MHZ 0402	8n2H	normal,-5%,+5%	0402L	X	X	X	X	
	3646009	Bot- tom	G	4	CHIP COIL 10N J Q28/ 800MHZ 0402	10N 10nH	normal,-5%,+5%	0402L					X
L608	3646051	Bot- tom	C	4	CHIP COIL 3N9 +-0N3 Q28/800M 0402	3n9H	normal,-0n3,+0n3	0402L					
L705	3646131	Bot- tom	G	6	CHIP COIL 3N9 +-0N1 Q28/1GHZ 0402	3n9H	normal,-0n1,+0n1	0402L_W065_POL					
L706	3646061	Bot- tom	H	6	CHIP COIL 15N J Q30/ 800M 0402	15nH	normal,-5%,5%	0402L	X	X	X	X	
	3646065	Bot- tom	H	6	CHIP COIL 12N J Q30/ 800M 0402	12nH	normal,-5%,5%	0402L					X
L707	3646061	Bot- tom	H	6	CHIP COIL 15N J Q30/ 800M 0402	15nH	normal,-5%,5%	0402L	X	X	X	X	
	3646077	Bot- tom	H	6	CHIP COIL 82N J Q30/ 800M 0402	82nH	normal,-5%,5%	0402L					X
L708	3646061	Bot- tom	H	6	CHIP COIL 15N J Q30/ 800M 0402	15nH	normal,-5%,5%	0402L	X	X	X	X	
	3646077	Bot- tom	H	6	CHIP COIL 82N J Q30/ 800M 0402	82nH	normal,-5%,5%	0402L					X
L710	3646043	Bot- tom	F	6	CHIP COIL 1N5 +-0N3 Q33/800M 0402	1n5H	normal,-0n3,0n3	0402L	NA	NA	NA	NA	NA
L711	3646069	Bot- tom	I	6	CHIP COIL 33N J Q23/ 800M 0402	33nH	normal,-5%,5%	0402L					
L712	3646117	Bot- tom	F	6	CHIP COIL 5N6 +-0N1 Q26/1GHZ 0402	5n6H	normal,-0n1,+0n1	0402L_H0.45	X	X			
	3646131	Bot- tom	F	6	CHIP COIL 3N9 +-0N1 Q26/1GHZ 0402	3N9H	normal,-0n1,+0n1	0402L_W065_POL			X	X	X
L730	3646131	Bot- tom	K	5	CHIP COIL 3N9 +-0N1 Q28/1GHZ 0402	3n9H	normal,-0n1,+0n1	0402L_W065_POL					
L732	3646005	Bot- tom	H	6	CHIP COIL 2N7+-0N3 Q29/800M 0402	2n7H	normal,-0n3,0n3	0402L	X	X	X	X	
	1430708	Bot- tom	H	6	Resistor 18 R 0W06	18R	normal,-0n3,0n3	0402L					X
L733	3646005	Bot- tom	H	6	CHIP COIL 2N7+-0N3 Q29/800M 0402	2n7H	normal,-0n3,0n3	0402L	X	X	X	X	
	1430708	Bot- tom	H	6	Resistor 18R 0W06	18R	normal,-0n3,0n3	0402L					X

Item	Product Code	Location				Description and value	Type	RH-19, HWID				RH-50	
		Side	Et	Grid	ref.			27 01	27 02	27 03	27 04		
L801	4551015	Bot- tom	D	6	DIR.COUP 897.5/ 1747.5/1880MHZ	897.5/ 1747.5/ 1880M	~	COUPLER_LDC15D	X	X	X	X	
	4550197	Bot- tom	D	6	DIR.COUP. 850/1800/ 1900 MHz	850/1800/ 1900 MHz	~	COUPLER_LDC15D					X
L802	3646047	Bot- tom	E	6	CHIP COIL 3N3 +-0N3 Q28/800M 0402	3n3H	normal,- 0n3,+0n3%	0402L	NA	NA	NA	NA	NA
L804	3203705	Bot- tom	H	9	FERRITE BEAD 42R/ 100MHZ 0805	42R/ 100MHz	~	0805_FERRITE					
L805	3203705	Bot- tom	I	9	FERRITE BEAD 42R/ 100MHZ 0805	42R/ 100MHz	~	0805_FERRITE					
L806	3646009	Bot- tom	D	9	CHIP COIL 10N J Q30/ 800M 0402	10nH	normal,-5%,5%	0402L	X	X	X	X	
	3646055	Bot- tom	D	9	CHIP COIL 8N2 J Q30/ 800M 0402	8n2H	normal,-5%,5%	0402L					X
L807	3646059	Bot- tom	E	9	CHIP COIL 5N6 +-0N3 Q28/800M 0402	5n6H	normal,-0n3,+0n3	0402L					
L808	3646065	Bot- tom	C	6	CHIP COIL 12N J Q31/ 800M 0402	12nH	normal,-5%,5%	0402L					
L809	3646043	Bot- tom	C	6	CHIP COIL 1N5 +-0N3 Q33/800M 0402	1n5H	normal,-0n3,0n3	0402L					
N100	4341063	Top	T	7	REG 2.8V/150MA LP3985 SOT23-5	~	~	SOT23_5_H1.2					
N150	4341221	Bot- tom	O	7	AF AMP 0.4W/2.6V LM4890 USMD9	~	~	USMD9_AAB					
N300	4341309	Bot- tom	N	9	DC/DC CONV 350MA TK11851 SSOP8	~	~	SOT23L_8					
N601	4370867	Bot- tom	H	5	MJOELNER RF ASIC PMB3346 LFBGA80	~	~	LFBGA_80					
N801	4350369	Bot- tom	D	7	PW AMP QCPM-8893 900/1800/1900MHZ	~	~	PW_AMP_PA_HDG 13	X	X			
	4350409	Bot- tom	D	7	PW AMP PF08125B-03 GSM900/1800/ 1900MHZ	~	~	PW_AMP_PA_HDG 13			X	X	
	4359007	Bot- tom	D	7	PW AMP PF08132B 850/1800/19000 MHz	~	~	PW_AMP_PA_HDG 13					X
R100	1620027	Bot- tom	R	7	RES NETWORK 0W06 2X47R J	2x47R	normal,-5%,5%	0404_R_SR					
R101	1620027	Bot- tom	R	7	RES NETWORK 0W06 2X47R J	2x47R	normal,-5%,5%	0404_R_SR					
R102	1620027	Bot- tom	R	7	RES NETWORK 0W06 2X47R J	2x47R	normal,-5%,5%	0404_R_SR					
R103	4120011	Bot- tom	R	7	ZDIX4 IP4043CX5 CA 14V2 10W CSP5	~	~	uBGA5					

Item	Product Code	Location			Description and value	Type	RH-19, HWID				RH-50	
		Side	Et	Grid ref.			27 01	27 02	27 03	27 04		
R104	1430812	Bot- tom	R	7	Resistor 5% 63mW 220k	normal,-5%,5%	0402R					
R105	1825031	Top	T	8	VARISTOR ARRAY 2XVWM16V VC50 0405	~	0405_2					
R106	1820039	Bot- tom	O	6	NTC RES 47K J B=4050+-3% 0402	normal,-5%,5%	0402_NTH5					
R107	1430804	Top	T	7	Resistor 5% 63mW 100k	normal,-5%,5%	0402R					
R108	1430690	Bot- tom	R	9	Chipres 0W06 jumper 0402	normal,-,-	0402R	NA	NA	NA	NA	NA
R109	1430804	Bot- tom	R	8	Resistor 5% 63mW 100k	normal,-5%,5%	0402R					
R110	1825031	Bot- tom	R	8	VARISTOR ARRAY 2XVWM16V VC50 0405	~	0405_2					
R151	1825031	Top	C	5	VARISTOR ARRAY 2XVWM16V VC50 0405	~	0405_2					
R153	1620105	Bot- tom	N	7	RES NETWORK 0W06 2X2k2 J 0404	~	MNR02					
R155	1825031	Bot- tom	S	4	VARISTOR ARRAY 2XVWM16V VC50 0405	~	0405_2					
R156	1430762	Bot- tom	O	7	Resistor 5% 63mW 2k2	normal,-5%,5%	0402R					
R158	1430752	Bot- tom	O	9	Resistor 5% 63mW 820R	normal,-5%,5%	0402R					
R159	1430754	Bot- tom	N	7	Resistor 5% 63mW 1k0	normal,-5%,5%	0402R					
R160	1430734	Bot- tom	O	7	Resistor 5% 63mW 220R	normal,-5%,5%	0402R					
R162	1620105	Bot- tom	N	8	RES NETWORK 0W06 2X2k2 J 0404	~	MNR02					
R163	1430786	Bot- tom	N	7	Resistor 5% 63mW 18k	normal,-5%,5%	0402R					
R164	1620105	Bot- tom	N	7	RES NETWORK 0W06 2X2K2 J 0404	normal,-5%,5%	MNR02_SR					
R166	1430786	Bot- tom	O	7	Resistor 5% 63mW 18k	normal,-5%,5%	0402R					
R167	1430778	Bot- tom	N	6	Resistor 5% 63mW 10k	normal,-5%,5%	0402R					
R168	1430804	Bot- tom	O	6	Resistor 5% 63mW 100k	normal,-5%,5%	0402R					
R171	1430754	Bot- tom	O	8	Resistor 5% 63mW 1k0	normal,-5%,5%	0402R					
R172	1430790	Bot- tom	N	8	Resistor 5% 63mW 27k	normal,-5%,5%	0402R					

Item	Product Code	Location			Description and value	Type	RH-19, HWID				RH-50	
		Side	Et	Grid ref.			27 01	27 02	27 03	27 04		
R173	1430734	Bot- tom	N	8	Resistor 5% 63mW 220R	normal,-5%,5%	0402R					
R175	1430754	Bot- tom	N	8	Resistor 5% 63mW 1k0	normal,-5%,5%	0402R					
R176	1430754	Bot- tom	N	8	Resistor 5% 63mW 1k0	normal,-5%,5%	0402R					
R200	1414605	Bot- tom	K	6	CHIPRES 0W25 0R22 J 0805	OR22	normal,-5%,5%	0805R_THERM1				
R202	1620043	Bot- tom	L	9	RES NETWORK 0W03 4X100K J 0804	4x100k	~	EXB28V				
R206	1430770	Bot- tom	L	0	Resistor 5% 63mW 4k7	normal,-5%,5%	0402R					
R207	1430770	Bot- tom	N	6	Resistor 5% 63mW 4k7	normal,-5%,5%	0402R					
R300	1430712	Bot- tom	N	9	Resistor 5% 63mW 27R	normal,-5%,5%	0402R					
R301	1430726	Bot- tom	N	9	Resistor 5% 63mW 100R	normal,-5%,5%	0402R					
R303	1430726	Bot- tom	R	8	Resistor 5% 63mW 100R	normal,-5%,5%	0402R					
R305	1430804	Bot- tom	R	5	Resistor 5% 63mW 100k	normal,-5%,5%	0402R					
R306	1430790	Bot- tom	B	6	Resistor 5% 63mW 27k	normal,-5%,5%	0402R					
R308	1430734	Bot- tom	F	8	Resistor 5% 63mW 220R	normal,-5%,5%	0402R					
R309	1430734	Bot- tom	F	8	Resistor 5% 63mW 220R	normal,-5%,5%	0402R					
R310	1430734	Bot- tom	F	8	Resistor 5% 63mW 220R	normal,-5%,5%	0402R					
R313	1430726	Bot- tom	K	9	Resistor 5% 63mW 100R	normal,-5%,5%	0402R					
R314	1430690	Bot- tom	Q	5	Chipres 0W06 jumper 0402	0R	normal,-,-	0402R	NA	NA	NA	NA
R315	1430790	Bot- tom	N	6	Resistor 5% 63mW 27k	normal,-5%,5%	0402R					
R316	1430812	Bot- tom	N	6	Resistor 5% 63mW 220k	normal,-5%,5%	0402R		NA	NA	NA	NA
R317	1825031	Bot- tom	S	4	VARISTOR ARRAY 2XVWM16V VC50 0405	2XVWM 16V	~	0405_2				
R318	1825031	Bot- tom	R	8	VARISTOR ARRAY 2XVWM16V VC50 0405	2XVWM 16V	~	0405_2				
R319	1430690	Bot- tom	Q	5	Chipres 0W06 jumper 0402	0R	normal,-,-	0402R	NA	NA	NA	NA

Item	Product Code	Location			Description and value	Type	RH-19, HWID				RH-50		
		Side	Et	Grid ref.			27 01	27 02	27 03	27 04			
R322	1430690	Bot- tom	J	9	Chipres 0W06 jumper 0402	OR	normal,-,-	0402R	NA	NA	NA	NA	NA
R324	1430762	Bot- tom	J	9	Resistor 5% 63mW	2k2	normal,-5%,5%	0402R	NA	NA	NA	NA	NA
R388	4120071	Bot- tom	O	9	ASIP EMIF03-SIM01 SIM FILTER BGA8	~	~	uBGA8					
R420	1430754	Bot- tom	L	6	Resistor 5% 63mW	1k0	normal,-5%,5%	0402R					
R422	1430790	Bot- tom	J	9	Resistor 5% 63mW	27k	normal,-5%,5%	0402R					
R424	1430812	Bot- tom	I	4	Resistor 5% 63mW	220k	normal,-5%,5%	0402R	NA	NA	NA	NA	NA
R426	1430754	Bot- tom	K	6	Resistor 5% 63mW	1k0	normal,-5%,5%	0402R					
R450	1430770	Bot- tom	P	6	Resistor 5% 63mW	4k7	normal,-5%,5%	0402R					
R606	1430690	Bot- tom	H	3	Chipres 0W06 jumper 0402	OR	normal,-,-	0402R	NA	NA	NA	NA	NA
R610	1430710	Bot- tom	H	3	Resistor 5% 63mW	22R	normal,-5%,5%	0402R					
R612	1430754	Bot- tom	H	4	Resistor 5% 63mW	1k0	normal,-5%,5%	0402R					
R617	1430718	Bot- tom	I	4	Resistor 5% 63mW	47R	normal,-5%,5%	0402R					
R619	1430690	Bot- tom	I	4	Chipres 0W06 jumper 0402	OR	normal,-,-	0402R	NA	NA	NA	NA	NA
R622	1430690	Bot- tom	I	3	Chipres 0W06 jumper 0402	OR	normal,-,-	0402R	NA	NA	NA	NA	NA
R623	1430726	Bot- tom	I	5	Resistor 5% 63mW	100R	normal,-5%,5%	0402R					
R625	1430718	Bot- tom	I	5	Resistor 5% 63mW	47R	normal,-5%,5%	0402R					
R626	1430846	Bot- tom	H	4	Resistor 1% 63mW	2k7	normal,-1%,1%	0402R					
R627	1430690	Bot- tom	I	5	Chipres 0W06 jumper 0402	OR	normal,-,-	0402R	NA	NA	NA	NA	NA
R628	1430693	Bot- tom	I	6	Chipres 0W06 5R6 J 0402	5R6	normal,-5%,5%	0402R					
R629	1430693	Bot- tom	I	5	Chipres 0W06 5R6 J 0402	5R6	normal,-5%,5%	0402R					
R630	1430718	Bot- tom	I	4	Resistor 5% 63mW	47R	normal,-5%,5%	0402R					
R701	1430690	Bot- tom	G	4	Chipres 0W06 jumper 0402	OR	normal,-,-	0402R	NA	NA	NA	NA	NA

Item	Product Code	Location			Description and value	Type	RH-19, HWID				RH-50		
		Side	Et	Grid ref.			27 01	27 02	27 03	27 04			
R702	1430690	Bot- tom	G	4	Chipres 0W06 jumper 0402	OR	normal,-,-	0402R	NA	NA	NA	NA	NA
R703	1430690	Bot- tom	G	4	Chipres 0W06 jumper 0402	OR	normal,-,-	0402R	NA	NA	NA	NA	NA
R705	1430690	Bot- tom	I	6	Chipres 0W06 jumper 0402	OR	normal,-,-	0402R	NA	NA	NA	NA	NA
R706	1430792	Bot- tom	I	6	Resistor 5% 63mW	33k	normal,-5%,5%	0402R					
R707	1430778	Bot- tom	I	6	Resistor 5% 63mW	10k	normal,-5%,5%	0402R					
R708	1430770	Bot- tom	I	6	Resistor 5% 63mW	4k7	normal,-5%,5%	0402R					
R709	1430762	Bot- tom	C	5	Resistor 5% 63mW	2k2	normal,-5%,5%	0402R	NA	NA	NA	NA	NA
R710	1430865	Bot- tom	J	5	CHIPRES 0W06 5K6 F 0402	5k6	normal,-1%,1%	0402R					
R711	1430776	Bot- tom	K	3	Resistor 5% 63mW	8k2	normal,-5%,5%	0402R					
R713	1620065	Bot- tom	J	5	RES NETWORK 0W06 4X5K6 J 0804	4x5.6k	normal,-5%,5%	MNR04					
R717	1620105	Bot- tom	J	6	RES NETWORK 0W06 2X2K2 J 0404	2x2k2	normal,-5%,5%	MNR02_SR					
R718	1430778	Bot- tom	I	6	Resistor 5% 63mW	10k	normal,-5%,5%	0402R	NA	NA	NA	NA	NA
R720	1430730	Bot- tom	G	6	Resistor 5% 63mW	150R	normal,-5%,5%	0402R					
R721	1430730	Bot- tom	G	6	Resistor 5% 63mW	150R	normal,-5%,5%	0402R					
R725	1430724	Bot- tom	H	6	Resistor 5% 63mW	82R	normal,-5%,5%	0402R					
R726	1430724	Bot- tom	H	6	Resistor 5% 63mW	82R	normal,-5%,5%	0402R					
R729	1620507	Bot- tom	E	9	RES NETWORK 0W04 3DB ATT 0404	292R/17R6/ 292R	~	0404_RAC10					
R731	1620507	Bot- tom	K	5	RES NETWORK 0W04 3DB ATT 0404	292R/17R6/ 292R	~	0404_RAC10					
R801	1430770	Bot- tom	D	5	Resistor 5% 63mW	4k7	normal,-5%,5%	0402R					
R802	1430726	Bot- tom	C	5	Resistor 5% 63mW	100R	normal,-5%,5%	0402R					
R803	1430718	Bot- tom	E	6	Resistor 5% 63mW	47R	normal,-5%,5%	0402R					
R804	1430690	Bot- tom	C	5	Chipres 0W06 jumper 0402	OR	normal,-,-	0402R	NA	NA	NA	NA	NA

Item	Product Code	Location			Description and value	Type	RH-19, HWID				RH-50		
		Side	Et	Grid ref.			27 01	27 02	27 03	27 04			
R805	1620517	Bot- tom	C	9	RES NETWORK 0W04 6DB ATT 0404	150R/37R4/ 150R	~						
R817	1430754	Bot- tom	C	9	Resistor 5% 63mW	1k0	normal,-5%,5%						
R818	1430726	Bot- tom	D	9	Resistor 5% 63mW	100R	normal,-5%,5%						
R819	1620507	Bot- tom	E	9	RES NETWORK 0W04 3DB ATT 0404	292R/17R6/ 292R	~						
R820	1430754	Bot- tom	D	9	Resistor 5% 63mW	1k0	normal,-5%,5%						
R821	1430726	Bot- tom	E	9	Resistor 5% 63mW	100R	normal,-5%,5%						
R822	1430766	Bot- tom	E	9	Resistor 5% 63mW	3k9	normal,-5%,5%						
R823	1430732	Bot- tom	E	1 0	Resistor 5% 63mW	180R	normal,-5%,5%						
R831	1430690	Bot- tom	C	5	Chipres 0W06 jumper 0402	OR	normal,-,-		NA	NA	NA	NA	NA
R832	1430690	Bot- tom	C	5	Chipres 0W06 jumper 0402	OR	normal,-,-		NA	NA	NA	NA	NA
S302	5200025	Bot- tom	B	6	SM TACT SW SIDE TRAVEL 0.2MM	~	~						
T701	4550191	Bot- tom	F	6	TRANSF BALUN 1800+- 100MHZ 2X1.25	~	~						
T702	4550179	Bot- tom	I	6	BALUN TRANS 3.7GHZ+/-300MHZ 0805	~	~						
V100	4113721	Top	T	5	TVS DI 1PMT16AT3 16V 175W PWRMITE	~	~						
V300	4110479	Bot- tom	N	9	SCH DI 1PS79SB31 200MA 30V SOD523	~	~						
V310	4864577	Top	R	5	LED SML512WBC2WT86N 0603	~	~						
V311	4864577	Top	R	7	LED SML512WBC2WT86N 0603	~	~						
V318	4864577	Top	O	5	LED SML512WBC2WT86N 0603	~	~						
V319	4864577	Top	O	7	LED SML512WBC2WT86N 0603	~	~						
V322	4864577	Top	L	5	LED SML512WBC2WT86N 0603	~	~						

Item	Product Code	Location			Description and value	Type	RH-19, HWID				RH-50	
		Side	Et	Grid ref.			27 01	27 02	27 03	27 04		
V323	4864577	Top	L	8	LED SML512WBC2WT86N 0603	~	~					
V801	4115821	Bottom	C	5	SCHDIX2 HSMS282C 15V <1PF SOT323	~	~					
V802	4210171	Bottom	D	9	TR NE68119 ***RESERVED HDB12***	~	~					
X101	5460061	Bottom	T	7	SM SYSTEM CONNECTOR 14POL	~	~					
X103	5409253	Bottom	G	8	SM BATTERY CONN 3POL SPR 12V 2A	~	~					
X302	5469175	Top	B	8	SM CONN BTB 2X5 F P0.5	~	~					
X387	5409219	Bottom	Q	8	SM WIM CONNECTOR 6POL P2.54	~	~					
Z601	4510385	Bottom	E	5	DIPL+3XSW 880-960/1710-1990MHZ 7X5	880-960/1710-1990MHz	~		X	X	X	X
	4550281	Bottom	E	5	DIPL+3 SW 824-894/1710-1990 MHz 7X5	824-894/1710-1990 MHz	~					X
Z602	4511313	Bottom	F	6	SAW FILT 1842.5+-37.5MHZ 2.5X2.0	1842.5MHz	~					
Z603	4511367	Bottom	F	5	SAW FILT 1960+-30MHZ 4DB 2.0X2.5	1960MHZ	~					
Z604	4511279	Bottom	F	4	SAW FILT 942.5+-17.5MHZ/3.5 2.5X2	942.5MHz	~		X	X	X	X
	4511323	Bottom	F	4	SAW FILT 881.5+-25MHz / 3dB	881.5 MHz	~					X
Z701	4511311	Bottom	H	6	SAW FILT 897.5+-17.5MHZ/3.5 2.5X2	897.5MHz	~		X	X	X	X
	4511317	Bottom	H	6	SAW FILT 836.5+-12MHz / 3dB 2.5x2.0	836.5 MHz	~					X

Component layout diagram Top

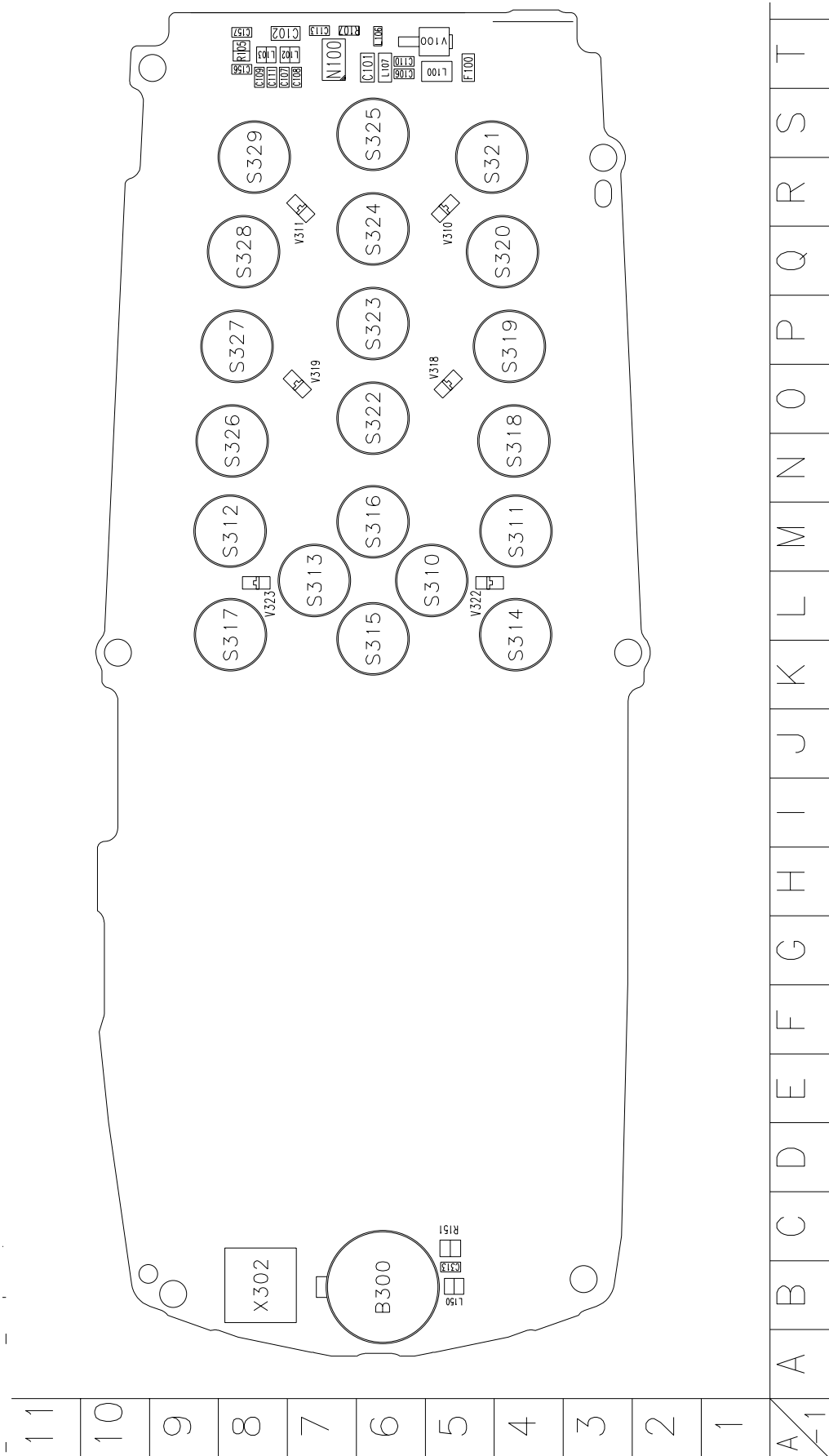

Component layout diagram Bottom

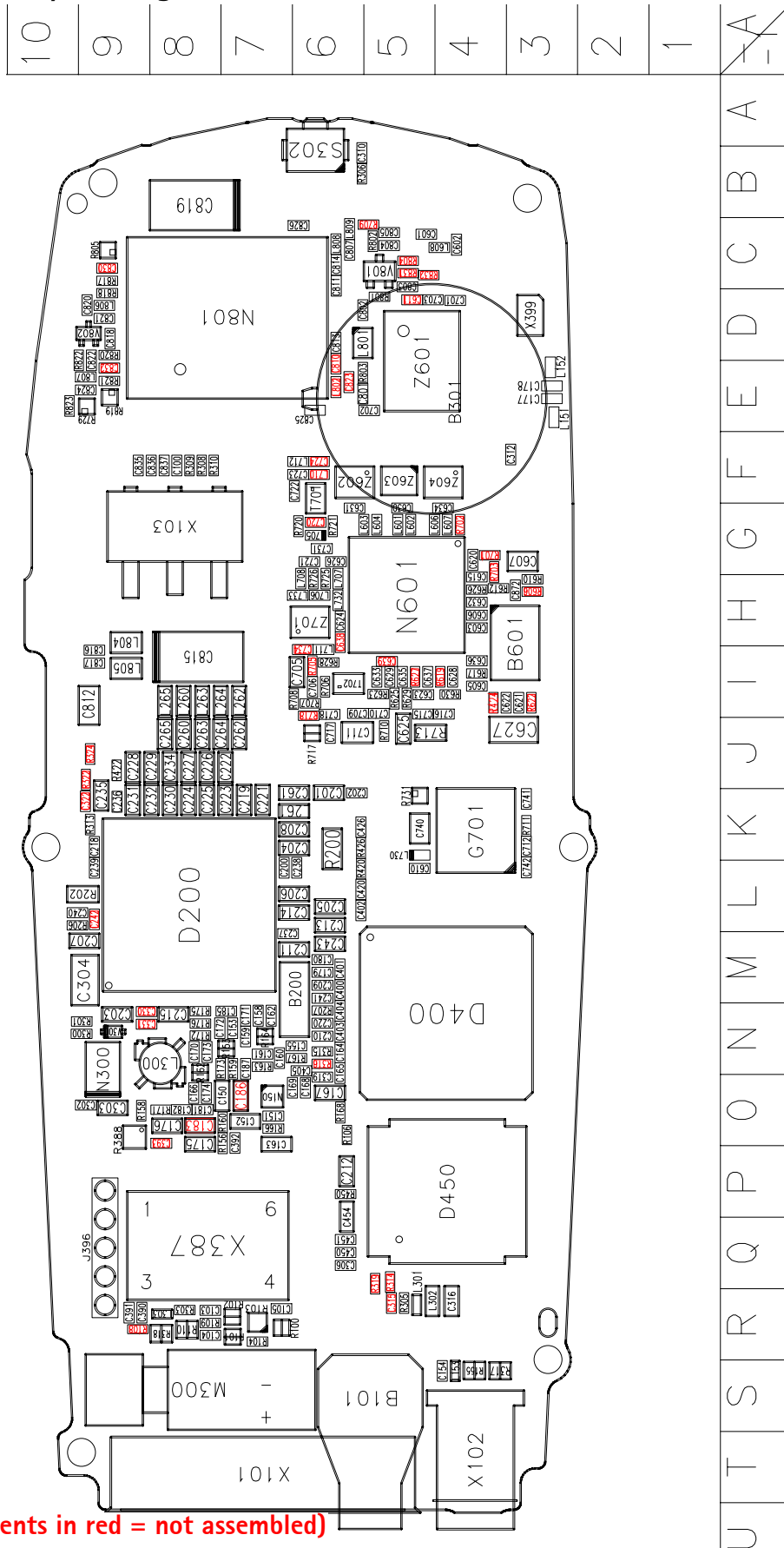

(Components in red = not assembled)